

# ASSEMBLY INSTRUCTION

ITEM : BM20015-QB

NO	PART LIST	QTY
1	HEADBOARD CUSHION	1PC
2	RIGHT HEADBOARD LEG WITH "R" LABEL	1PC
3	LEFT HEADBOARD LEG WITH "L" LABEL	1PC
4	LEFT WING	1PC
5	RIGHT WING	1PC
6	FOOTBOARD CUSHION	1PC
7	FOOTBOARD LEG	2PCS
8	SIDE RAIL (L/R)	2PCS
9	SIDE RAIL (L/R)	2PCS
10	SIDE RAIL SUPPORT LEG	2PCS
11	SLAT	4PCS
12	SUPPORT LEG WITH ADJUSTABLE FEET	4PCS
NO	HARDWARE LIST	QTY
A	JCBB SCREW M8 x 20mm	8PCS
B	JCBC SCREW M6 x 25mm	8PCS
C	JCBC SCREW M6 x 35mm	16PCS
D	JCBC SCREW M6 x 70mm	2PCS
E	WOOD DOWEL M8 x 30mm	2PCS
F	SPRING WASHER M6 x 13mm	20PCS
G	FLAT WASHER M6 x 19mm	20PCS
H	SCREW M4 x 32mm	8PCS
I	SCREW M4 x 38mm	4PCS
J	L - KEY M5 x 65mm	1PC
K	L - KEY M4 x 100mm	1PC

## STEP 1

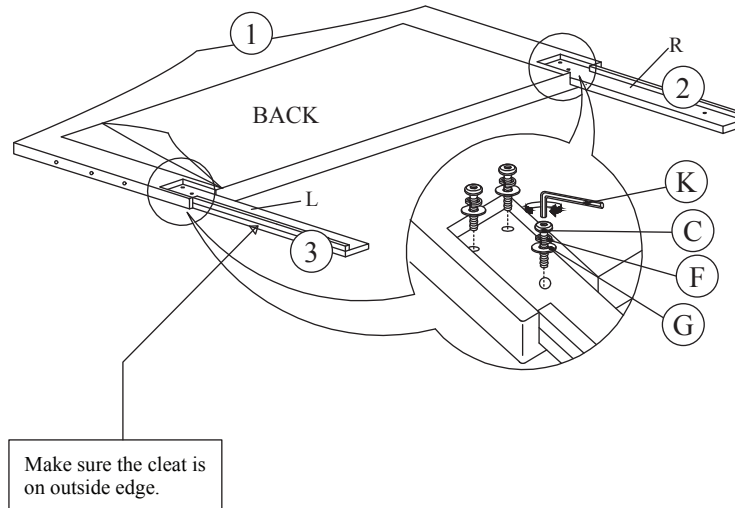

## STEP 2

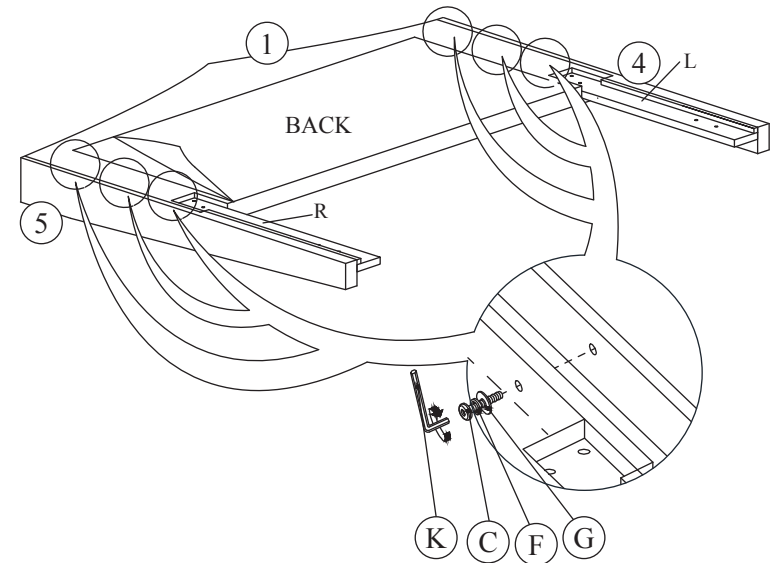

## STEP 3

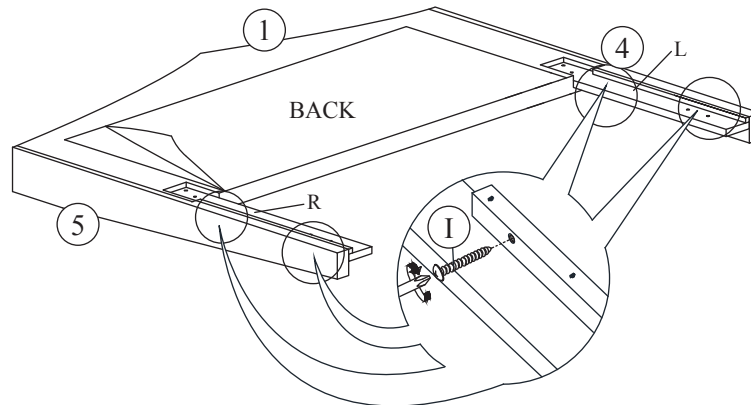

## STEP 4

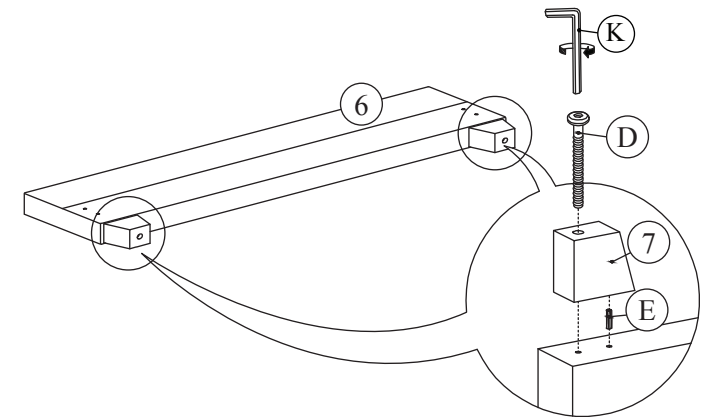

# ASSEMBLY INSTRUCTION

STEP 5

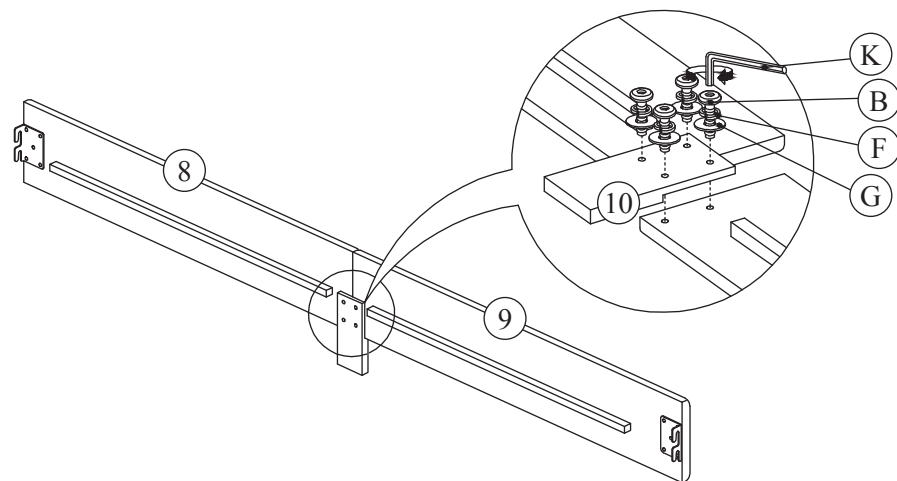

Do not fully tighten screws until assembly is complete and the bed is level

STEP 6

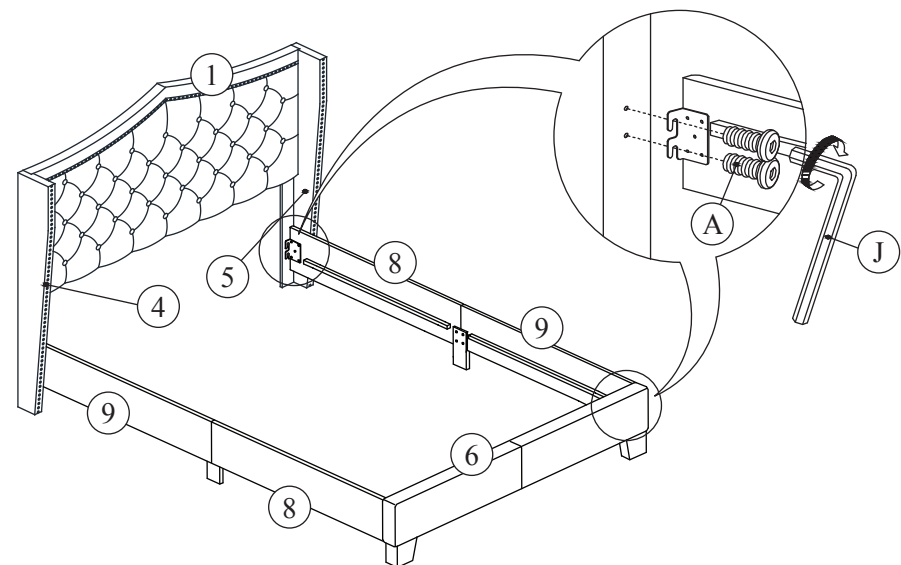

STEP 7

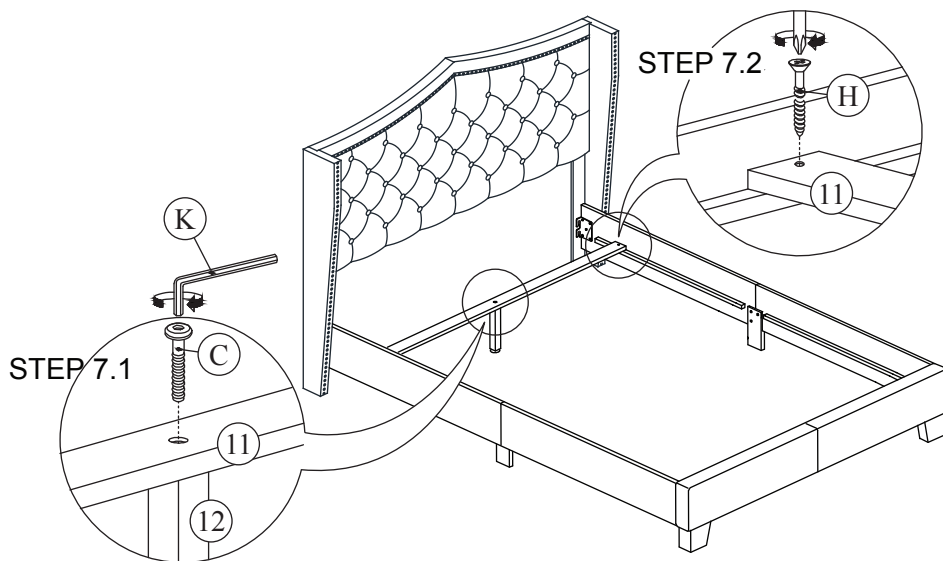

STEP 8

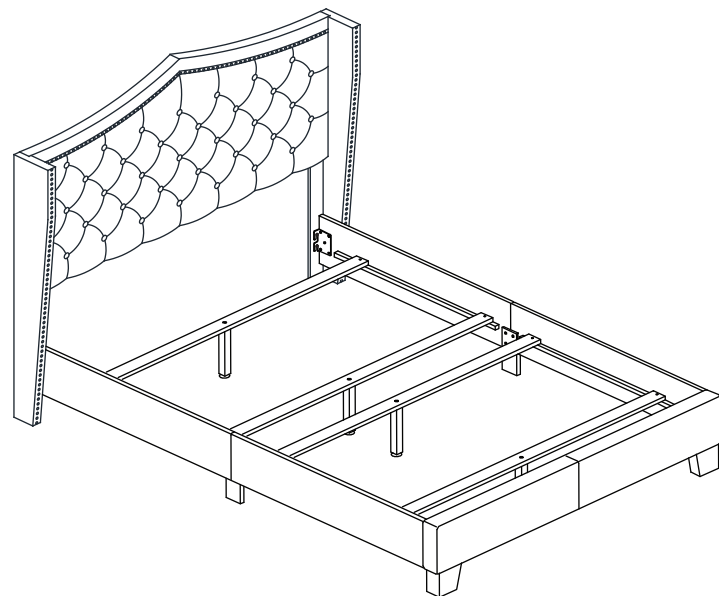

ASSEMBLY  
COMPLETED

NOTE: AFTER A FEW DAYS OF ASSEMBLY, IT WILL HAVE ACCLIMATIZED TO THE ENVIRONMENT. PLEASE TIGHTEN ALL HARDWARE. CHECK TIGHTNESS OF ALL SCREWS EVERY 6 - 8 WEEKS.