

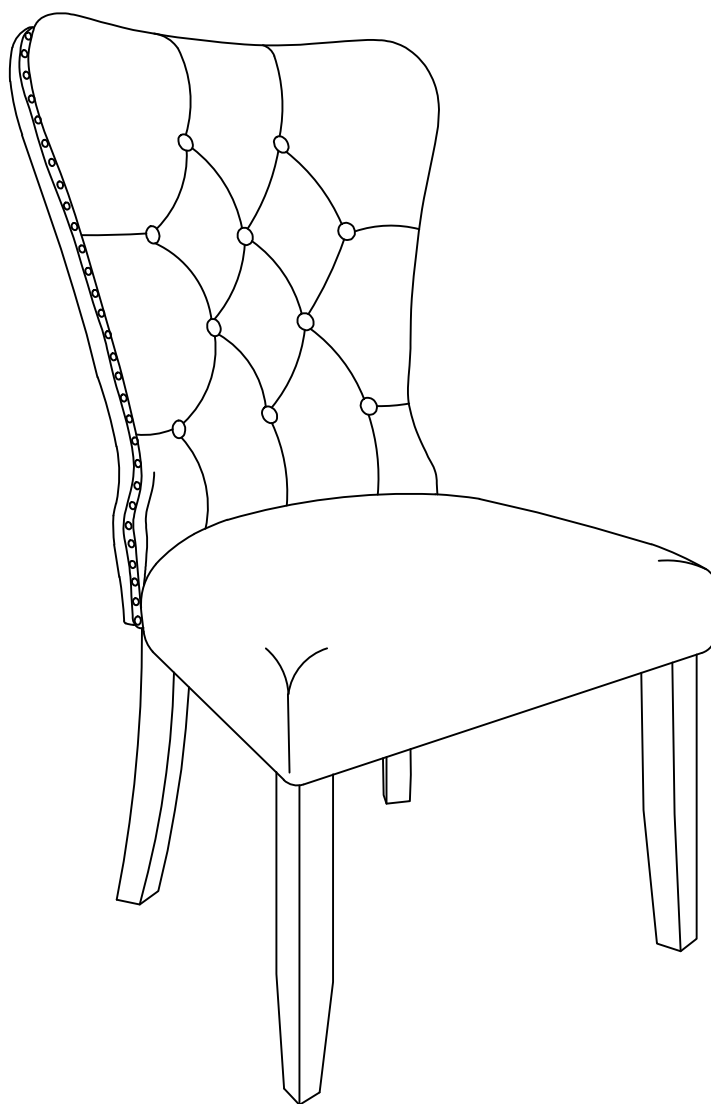

MOLLAI
COLLECTION

#DV1238-SC
SIDE CHAIR

ASSEMBLY INSTRUCTIONS



ASSEMBLY TIPS:

- 1.Remove hardware from box and sort by size.
- 2.Please check to see that all hardware and parts are present prior to start of assembly.
- 3.Please follow attached instructions in the same sequence as numbered to assure fast & easy assembly.

Warning!

1. Don't attempt to repair or modify parts that are broken or defective. Please contact the store immediately.
2. This product is for home use only and not intended for commercial establishment.

PARTS IDENTIFICATION

A



FABRIC ARM CHAIR

1PC

B

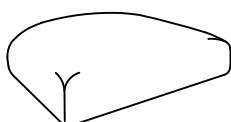

Seat

1PC

C

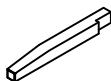

Front leg

2PCS

HARDWARE IDENTIFICATION

1



Bolt

4PCS

2

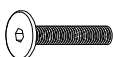

Bolt

4PCS

3



Lock washer

8PCS

4



Flat washer

8PCS

5



Allen wrench

1PC

STEP 1.

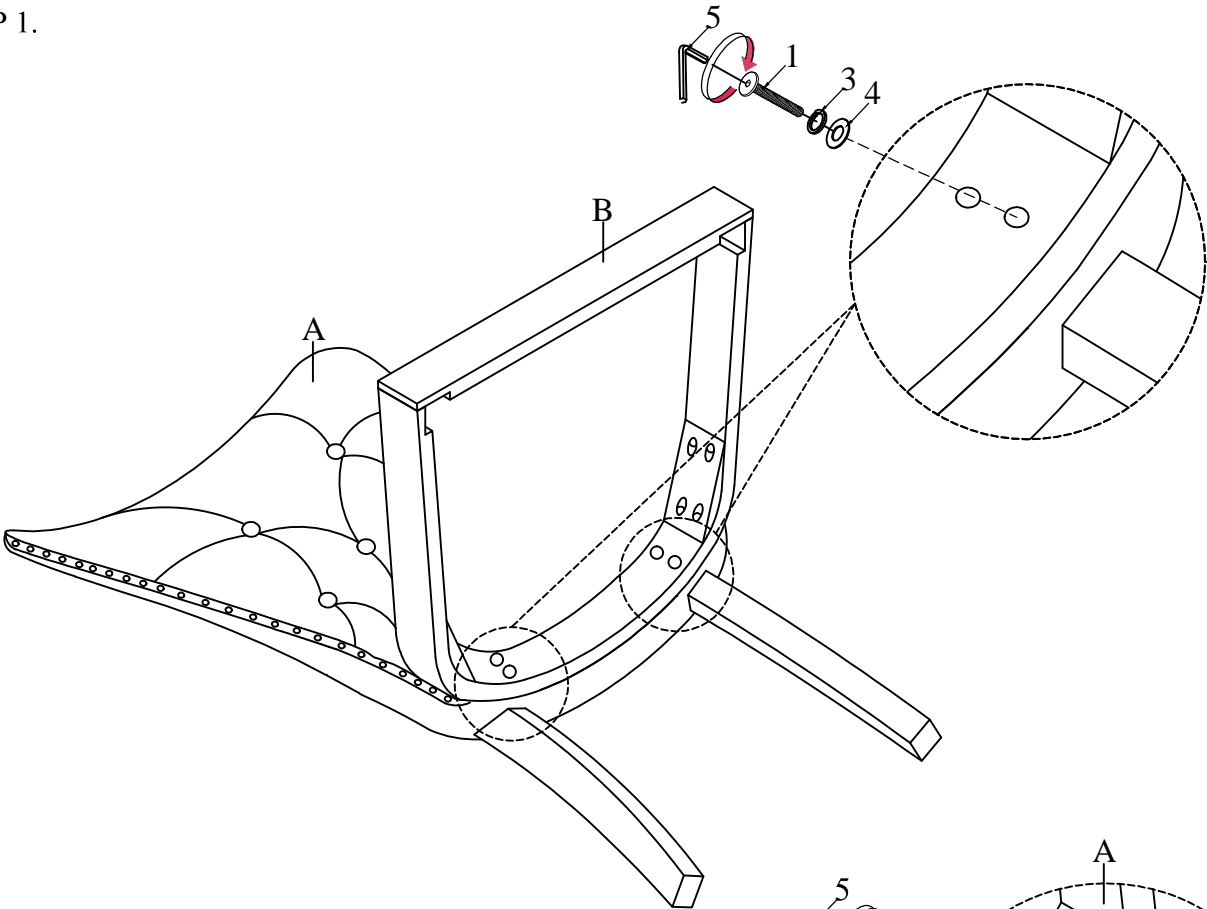

STEP 2.

