

BEL IMPORTS INC

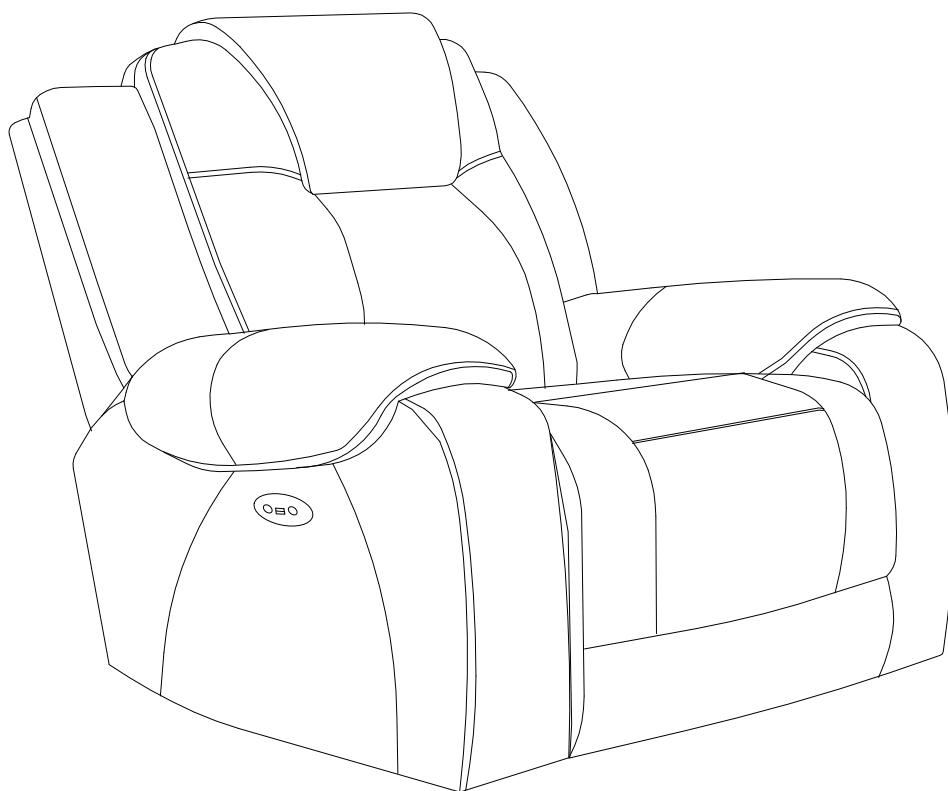

BF2503L-PRAC
Power recliner arm chair

ASSEMBLY INSTRUCTIONS



ASSEMBLY TIPS:

- 1. Remove hardware from box and sort by size.
- 2. Please check to see that all hardware and parts are present prior to start of assembly.
- 3. Please follow attached instructions in the same sequence as numbered to assure fast & easy assembly.



WARNING!
1. Don't attempt to repair or modify parts that are broken or defective. Please contact the store immediately.
2. This product is for home use only and not intended for commercial establishments.

1	SEAT BASE		1PC	2	BACKREST		1PC
3	LEFT WING		1PC	4	RIGTH WING		1PC
5	TRANSFORMER		1PC	6	PLUG		1PC

STEP 1:

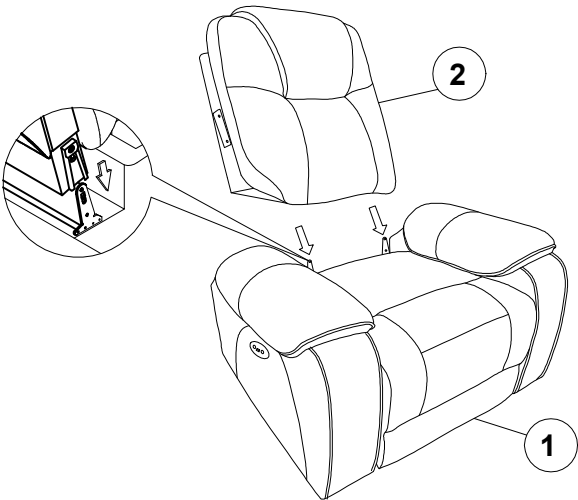

STEP 2:

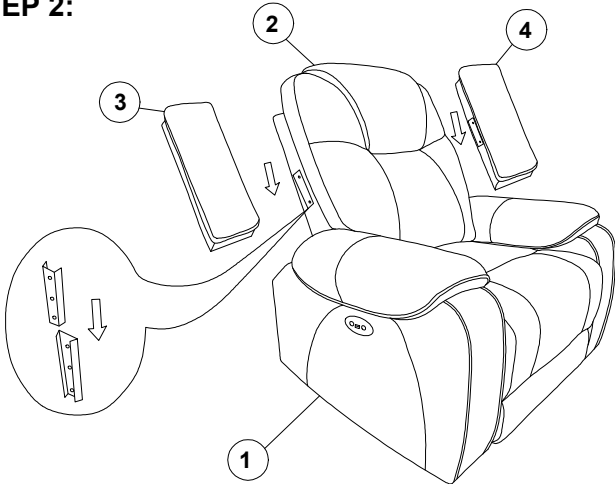

STEP 3:
COMPLETE

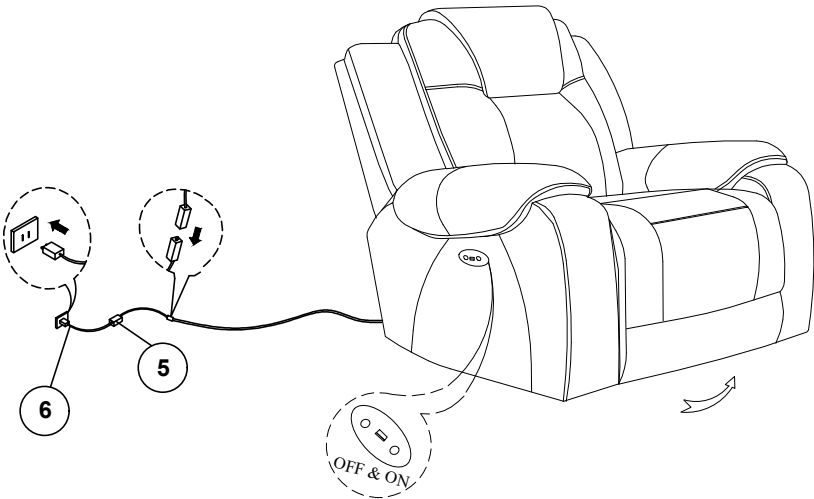

BEL IMPORTS INC



BF2503L-SLS
Stationary loveseat

ASSEMBLY INSTRUCTIONS

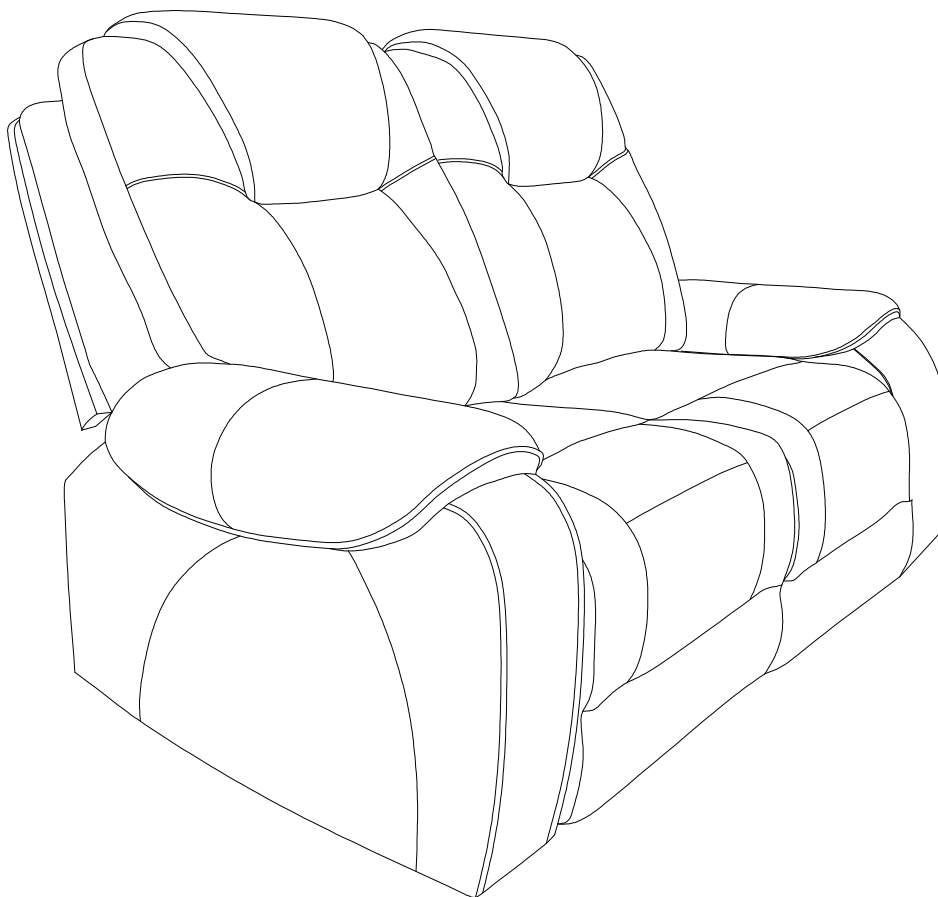

ASSEMBLY TIPS:

- 1. Remove hardware from box and sort by size.
- 2. Please check to see that all hardware and parts are present prior to start of assembly.
- 3. Please follow attached instructions in the same sequence as numbered to assure fast & easy assembly.



WARNING!
1. Don't attempt to repair or modify parts that are broken or defective. Please contact the store immediately.
2. This product is for home use only and not intended for commercial establishments.

1	SEAT BASE		1PC	2	LEFT BACKREST		1PC
3	RIGHT BACKREST		1PC	4	LEFT WING		1PC
5	RIGTH WING		1PC				

STEP 1:

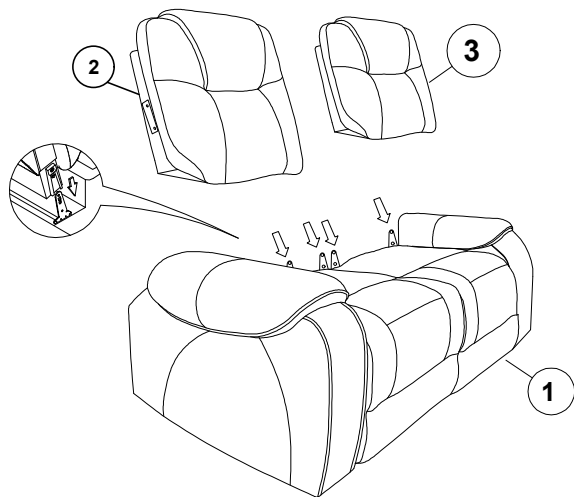

STEP 2:

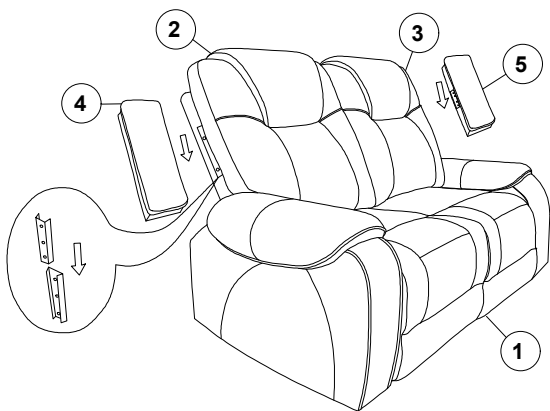

STEP 3:
COMPLETE

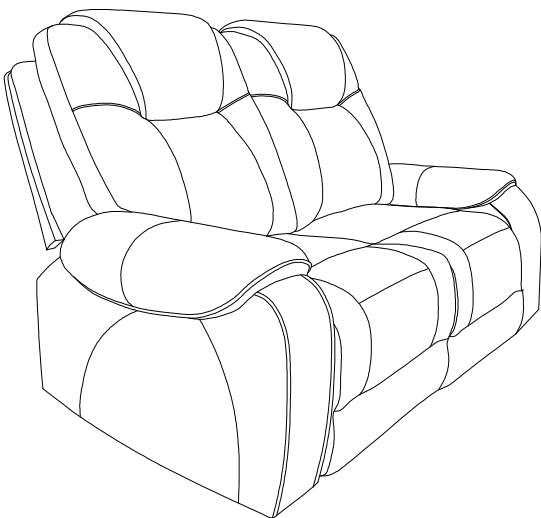

BEL IMPORTS INC



BF2503L-PSF
Power sofa

ASSEMBLY INSTRUCTIONS

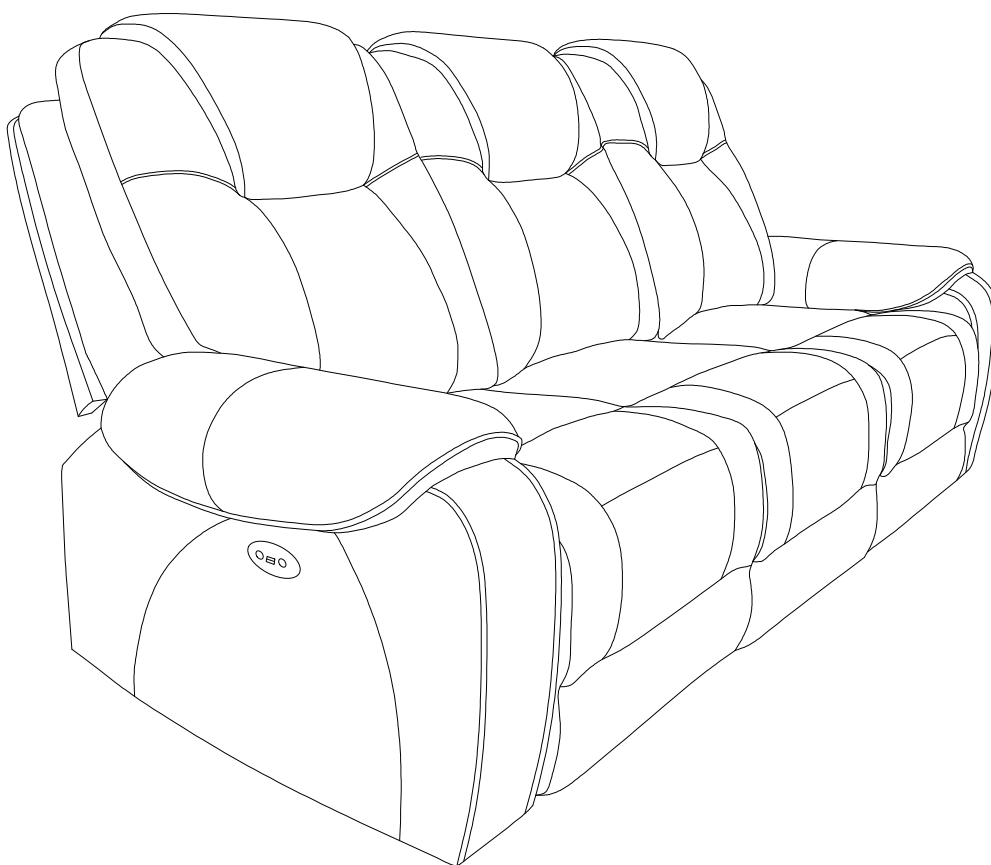

ASSEMBLY TIPS:

- 1. Remove hardware from box and sort by size.
- 2. Please check to see that all hardware and parts are present prior to start of assembly.
- 3. Please follow attached instructions in the same sequence as numbered to assure fast & easy assembly.



WARNING!
1. Don't attempt to repair or modify parts that are broken or defective. Please contact the store immediately.
2. This product is for home use only and not intended for commercial establishments.

1	SEAT BASE		1PC	2	LEFT BACKREST		1PC
3	MID BACKREST		1PC	4	RIGHT BACKREST		1PC
5	LEFT WING		1PC	6	RIGHTH WING		1PC
7	TRANSFORMER		1PC	8	PLUG		1PC

STEP 1:

STEP 2:

STEP 3:
COMPLETE