

# ASSEMBLY INSTRUCTION

**MODEL: DM20301 / DM20401 / DM20501 / DM20601 - PUB CHAIR**

Thank you for purchasing this products.This product has been designed for easy assembly and constructed for durability. Pleased take time to read and follow the assembly instructions.

## IMPORTANT NOTES :-

1. Please see the hardware & part list for guidance.
2. Please place all wooden parts on a clean and smooth surface such as rug or carpet to avoid the parts from being scratched.
3. Please check to ensure you have all parts and hardware's.
4. Do not tighten all screws / bolts until all completely assembled.

NO	PARS LIST (2 Pcs)	QTY
1	CHAIR BACK	2PCS
2	BOX SEAT	2PCS
3	FRONT LEG (L)	2PCS
4	FRONT LEG (R)	2PCS
5	CUSHION SEAT	2PCS
6	STRETCHER (L)	2PCS
7	STRETCHER (R)	2PCS
8	STRETCHER (A)	2PCS

NO	HARDWARE LIST (2 Pcs)		QTY
A		JCBC BOLT M6 x 40mm	4PCS
B		JCBC BOLT M6 x 55mm	8PCS
C		JCBC BOLT M6 x 70mm	8PCS
D		SPRING WASHER	20PCS
E		ALLEN KEY WITH BALL	1PC
F		FLAT WASHER	20PCS
G		CSK SCREW M4 x 32mm	18PCS

NOTE: THE LIST QUANTITY SHOW ABOVE IS FOR 1 UNIT ASSEMBLY.

## STEP 1

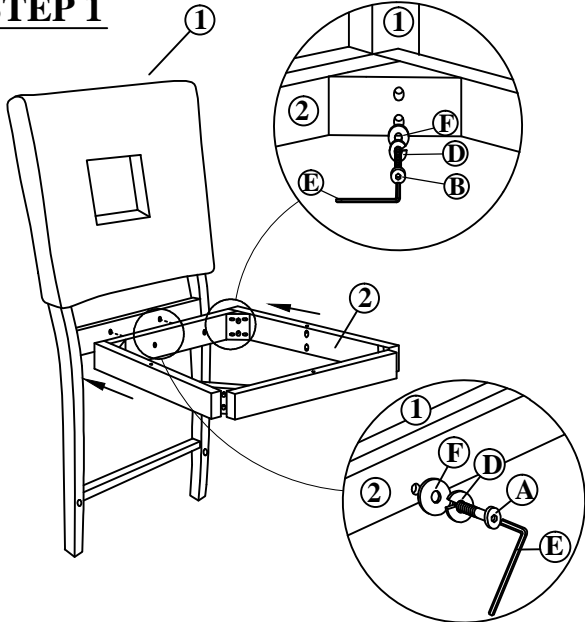

## STEP 2

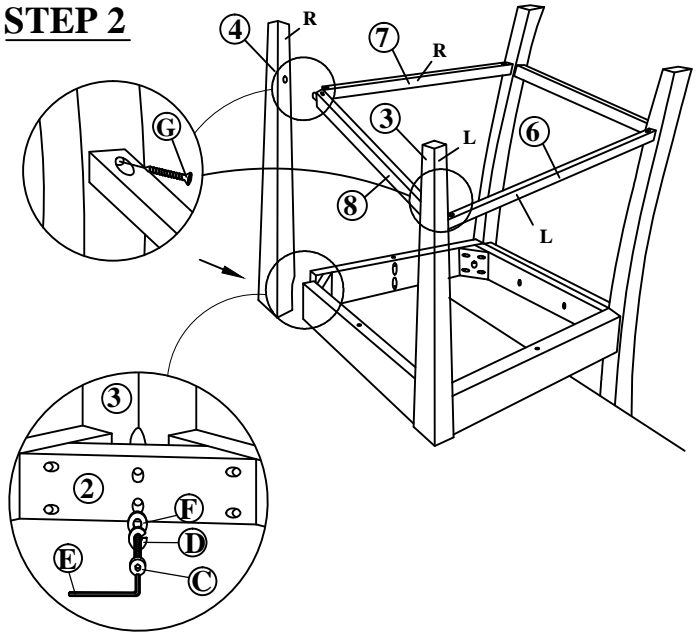

## STEP 3

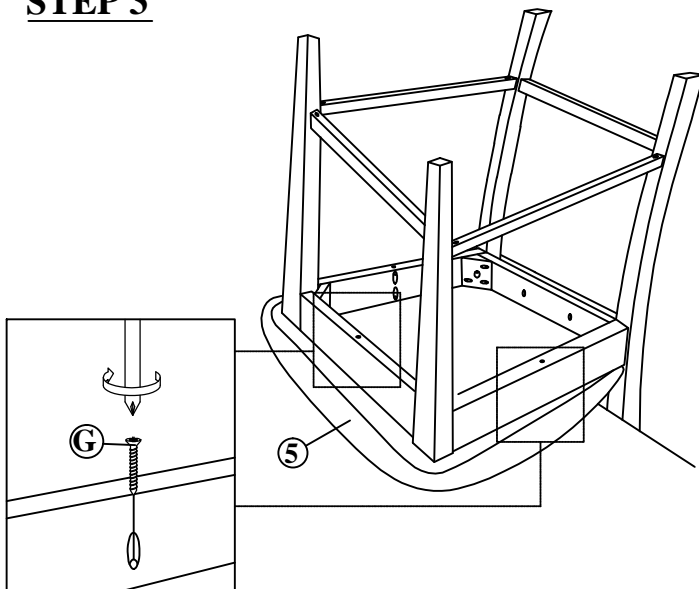

## STEP 4

